



# AmbiSort B-Series Solution Guide

AmbiSort B-Series Reinvigorates Your  
Entire Sortation Process. See How.

## AMBISORT B-SERIES

# Sort-to-Gaylord

AI-powered modular parcel induction and sorting system

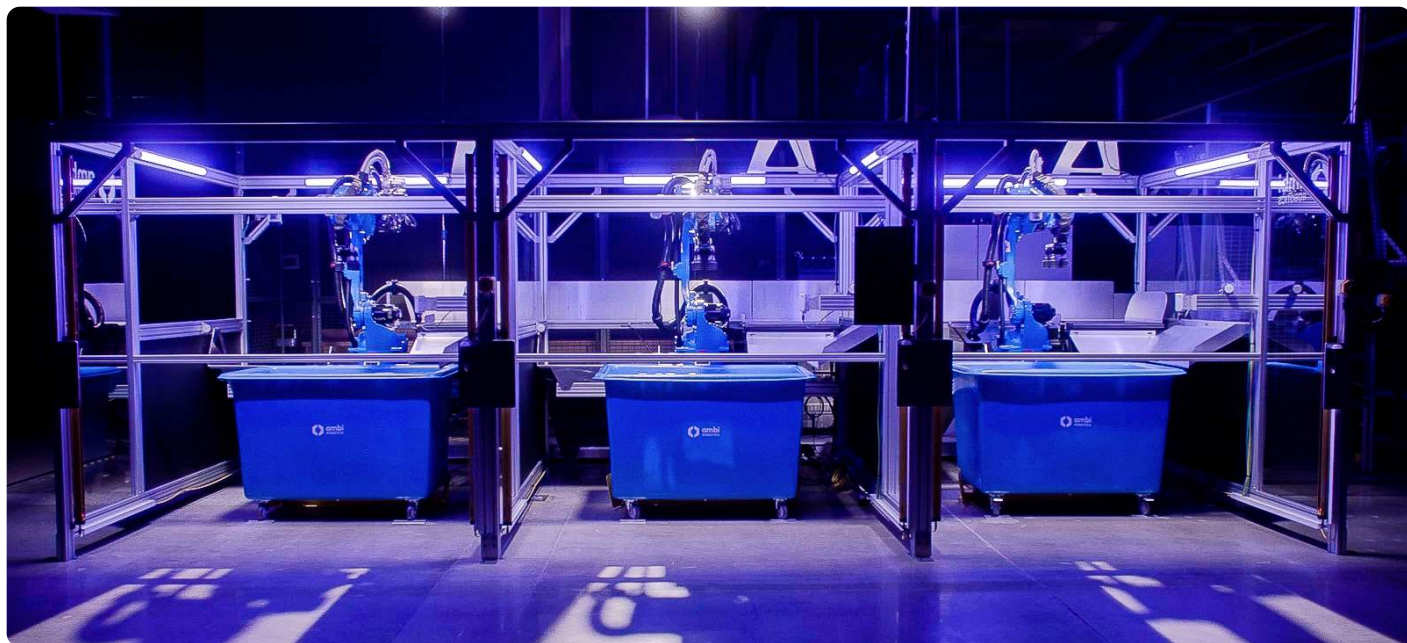

## A sorting solution built for more



### More flexibility

Customizable to your unique workflow and adapts to your diverse needs.



### More speed

Boost your productivity and accelerate your sorting operations with unmatched efficiency.



### More uptime

Maximize your operational continuity with around-the-clock, reliable performance.



### More accuracy

Achieve precise order accuracy and minimize your returns.



### More safety

Prioritize the well-being of your workers with built-in safety features.

## AMBISORT B-SERIES

# Product Specifications

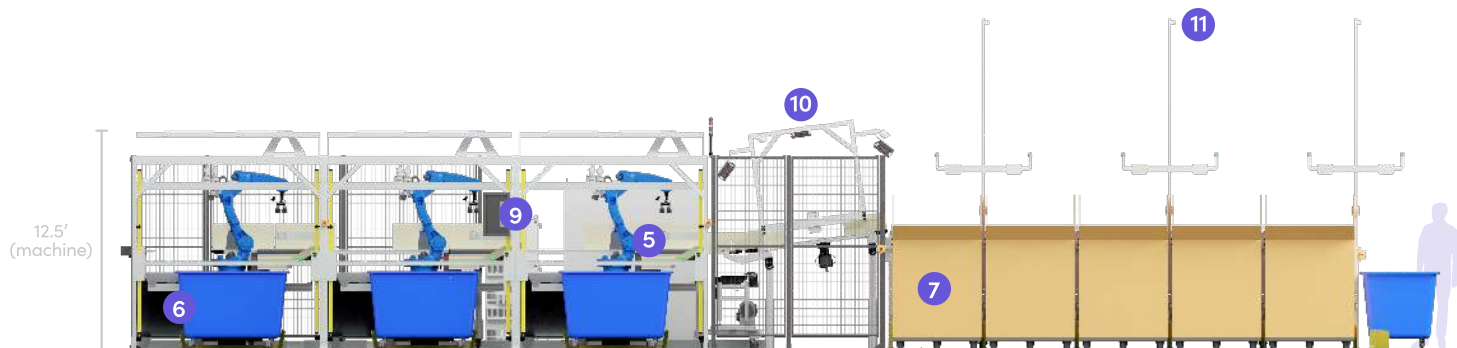

**+1,200** items sorted per hour

**>96%** of in-size parcels sortable

**>99%** sorted to correct outputs

**>99%** of desired uptime

This data is based on three induction cell configuration\*

### MACHINE COMPONENTS

- 1 Operator access gate
- 2 Central conveyor
- 3 ModSort® modules
- 4 Exceptions bin
- 5 Buffer
- 6 Input bin/conveyor\*
- 7 Gaylords
- 8 Oversized reject chute
- 9 Human machine interface (HMI)
- 10 6-sided scan tunnel
- 11 Depth cameras for gaylord fill level
- 12 Quality control zone

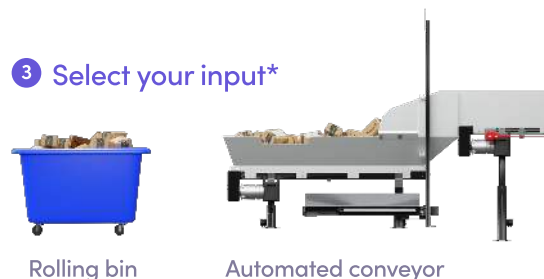

Rolling bin

Automated conveyor

## AMBISORT B-SERIES

# How It Works

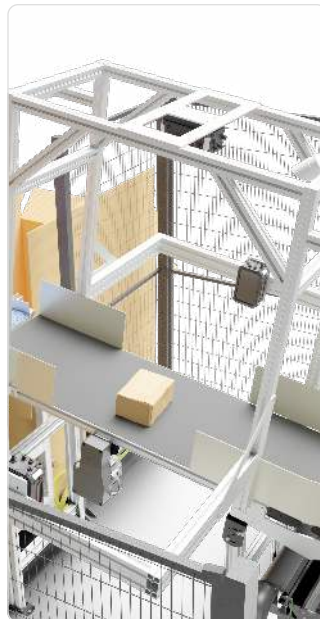

- 1** Plan & Identify
- 2** Grasp & Induct
- 3** Convey & Scan
- 4** Sort to gaylord

## Configurable at its core

Modular design allows for system configuration specific to your exact process

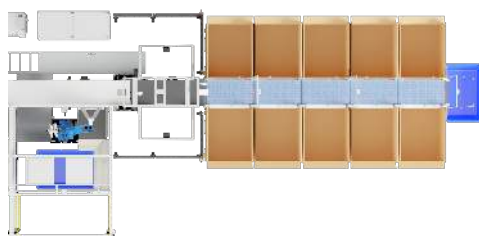
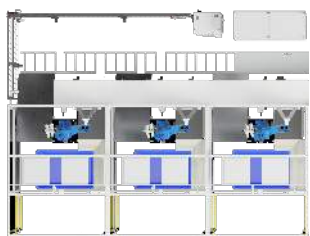

- 1** Induction cell  
 Automated induction from deep bin or conveyor
- 2** In line with robotic induction  
 Singulated stream is augmented with robotic induction
- 3** Vision-based sortation  
 Camera based tracking of sorted items allows for straight forward expansion of upstream sorters

# Application Use-Cases

Automated induction, reverse logistics, sort to carrier, zone skipping, sorter expansion, modular inter facility sortation, final-mile sortation and more

## Sort-to-Carrier

Sort between major carriers as well as shipment priority

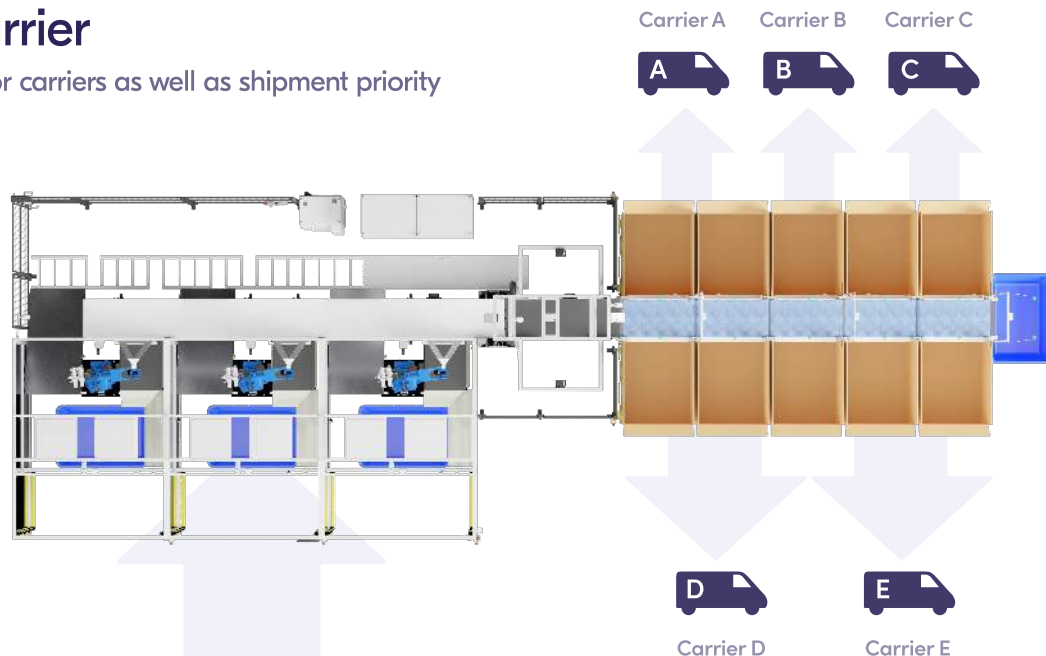

## Middle-Mile Sortation

Interfacility sortation + sorter expansion



## AMBISORT B-SERIES

# Now That You Know AmbiSort Get To Know Ambi Robotics

Ambi Robotics combines hardware and software for automated sorting solutions like AmbiSort B-Series. Powered by AmbiOS and Sim2Real AI, solutions seamlessly integrate modular components to power unique configuration. Optimize warehouse efficiency and safety in high-speed parcel sorting operations, by unlocking new levels of robotic dexterity.



Are you ready to handle more?

Configure your AmbiSort B-Series today →

